

TOGETHER WE'RE BETTER ON THE BOARDWALK OF EDUCATION



53RD ANNUAL CONFERENCE • OCTOBER 2-5, 2008 • LONG BEACH, CALIFORNIA



LONG BEACH WELCOMES THE CALIFORNIA ESCROW ASSOCIATION



**TOGETHER WE'RE BETTER ON THE
BOARDWALK OF EDUCATION**

GENERAL INFORMATION

Location

This year's conference will be held in Long Beach, California. The Long Beach Convention Center will serve as the main venue for the education sessions and the Escrow Expo. The Hyatt Hotel will serve as the host hotel and will accommodate our Saturday evening party and Sunday events. There are also overflow guest rooms blocked at the Renaissance Hotel.

Long Beach Convention Center

300 East Ocean Boulevard, Long Beach, CA 90802, 562.436.3636
www.longbeachcc.com



© Destinations Magazine



Hyatt Regency Long Beach Hotel

200 South Pine Avenue, Long Beach, CA 90802, 562.491.1234
www.hyatt.com
CEA Guest Room Rate - \$179 for single/double occupancy



Renaissance Long Beach Hotel

111 East Ocean Boulevard, Long Beach, CA 90802, 562.437.5900
www.renaissancelongbeach.com
CEA Guest Room Rate - \$169 for single/double occupancy.

Please make your hotel reservations by Monday, September 8, 2008 to insure availability and rate.

JetBlue Airlines is offering California Escrow Association conference attendees a 5% discount for travel to the CEA Conference.

**Please log on to:
www.jetblue.com/promo and enter the promo code of CaliforniaEscrow.**



GENERAL INFORMATION

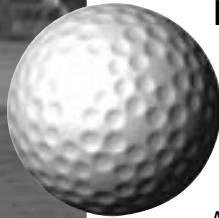

Escrow Awards Luncheon

This year's luncheon on Saturday will feature award presentations for outstanding achievement in the following areas: The Charles P. Conner Memorial Education Award, Regional Newsletter Award, Regional Community Spirit Award, Rose Pothier Scholarship Awards and the Lifetime Achievement Award. So, be sure to join us to celebrate your fellow escrow practitioners!

Escrow Expo - "The Midway"

Come see the latest in services and products to help make your job easier plus visit fun life style vendors who will help you get a jump start on your holiday gift giving. See page 7 of this brochure for a list of exhibitors and the Midway floor plan.

Cocktail Reception on the Midway

Join your fellow conventioners and visit with your exhibitor friends immediately following the education sessions on Friday, October 3rd for cocktails and hors d'oeuvres in the Escrow Expo.

More Information

California Escrow Association
www.ceaescrow.org
2520 Venture Oaks Way, Suite 150
Sacramento, CA 95833
916.239.4075 - phone
916.924.7323 - fax
cea@camgmt.com

Annual Golf Tournament Rancho San Joaquin Golf Course

Join your fellow golfers on Thursday, October 2, 2008 at the Rancho San Joaquin Golf Course for our annual shotgun golf tournament. We will tee off at 12:30 p.m., so please check in at 11:00 a.m. The golf course is located at One Ethel Coplen Way, Irvine, CA 92612 949.786.5522, www.rsj.americangolf.com. Transportation on own.

An Evening on the Boardwalk

This year's Saturday night party will be a fun and lively event with a carnival theme! This event will feature the annual installation of the 2009 CEA Executive Board, a welcome cocktail reception, dinner, entertainment, a casino night featuring blackjack tables, craps tables, poker tables, roulette and lots more!

This event will be held at the Hyatt Hotel on Saturday, October 4th beginning at 7:00 p.m. and will end at 11:00 p.m.



© Destinations Magazine

GENERAL INFORMATION

Conference Sponsorship/Exhibit Opportunities

There are several opportunities available for companies to sponsor items and to exhibit at this year's conference. For information about the sponsorships/exhibiting opportunities that are available, contact CEA Headquarters at cea@camgmt.com or 916.239.4075. You can also download the forms from www.ceaescrow.org.

Professional Designation Credits

P.D. holders can earn up to 15.25 continuing education credits and receive a discounted registration fee. Please refer to the barcode paragraph, below, for tracking details.

Barcode Scanner Program/PD Credit Tracking

Members must bring their current membership card to conference and use it to scan in and out of each session. Replacement cards will be available at the conference registration desk for a charge of \$15.00 each, or you may order one with your conference registration. It is mandatory that Professional Designation holders **scan in** at the beginning of each session **and scan out** at the completion of each session they are attending in order to receive their credit. No exceptions. Non-PD holders have the option of scanning in and out, and scanning is encouraged so that we can have accurate attendance counts.

General Information

Please complete the registration form included in this brochure and return it with your payment. Please note that registrations postmarked by September 2nd will receive an early bird discount of 10%. Please note the following items:

Confirmation of Registration – You will receive an e-mail confirming receipt of your registration.

Fees – All fees must accompany your registration. Registration deadlines include the postmark date.

Cancellation – All cancellations must be made in writing. Cancellations received on or before September 22, 2008 will receive a full refund LESS a \$50 processing fee. No refunds will be granted after September 22nd.

Company Discounts – Companies sending three or more employees to the conference may enjoy a 10% discount off of the registration fee. Please note, registration forms for each employee must be sent together with one company check or credit card for the total amount due. No exceptions.



© Long Beach Area Convention & Visitors Bureau

CONFERENCE SCHEDULE

15.5 PD Credits Available • All events held at the Long Beach Convention Center unless otherwise indicated.

THURSDAY, OCTOBER 2, 2008

- 8:00 a.m. – 5:00 p.m.** **Notary Class**
Duane Gomer
 Separate registration required, see insert.
- 10:30 a.m.** **Golf Tournament Check In**
Rancho San Joaquin Golf Course
One Ethel Copen Way, Irvine, CA
92612, 949.786.5522
- 12:30 p.m.** **Golf Tournament Shotgun Start**
- 1:00 p.m. – 5:00 p.m.** **Exhibitor Set-Up**
- 5:30 p.m. – 7:30 p.m.** **Conference Registration Open**

FRIDAY, OCTOBER 3, 2008

(6.25 Professional Designation Credits Available)

- 7:00 a.m. – 4:00 p.m.** **Registration Open**
- 7:00 a.m. – 8:00 a.m.** **Continental Breakfast in Exhibit Hall**
- 7:00 a.m. – 4:15 p.m.** **“Enjoy the Midway”**
Escrow Expo Open
- 8:00 a.m. – 8:45 a.m.** **Opening Ceremonies (.75 Credits)**
- 9:00 a.m. – 10:30 a.m.** **Breakout Sessions (1.5 Credits)**
- 1. “Merry Go Round of Taxes” (E)**
Michael Haas, CPA, Morton Alan Haas & Co.
- 2. “Sideshow”**
Beginning Bulk Sales (Level 2)
Nancy Stalter, CEO, CSEO, CBSS, CMHS, CEI, The Business of Escrow
Tamara Stoebe, CEO, CSEO, CBSS, CMHS, CEI, Federal Escrow/
Troth REALTORS GMAC Real Estate
- 3. “The Tarot Cards”**
Introduction to Defeasance (Level 3)
Patty Beverly, CSEO, CEI,
First American Title Company
Debbi Faber, CSEO, CBSS, CMHS, CEI,
Chicago Title Company
Matt Rothman, Vice President,
Commercial Defeasance, LLC
- 10:30 a.m. – 10:45 a.m.** **Expo Break**
- 10:45 a.m. – 12:15 a.m.** **Breakout Sessions (1.5 Credits)**
- 4. “Ride the Zipper”**
TIC’s (Level 3)
Michele Mesh, CEO, CSEO, CBSS, CEI,
LandAmerica Financial Group
- 5. “Freak Show”**
Advanced Bulk Sales (Level 3)
Nancy Stalter, CEO, CSEO, CBSS, CMHS, CEI, The Business of Escrow
Tamara Stoebe, CEO, CSEO, CBSS, CMHS, CEI, Federal Escrow/
Troth REALTORS GMAC Real Estate

LEVEL 1 - Beginner
 LEVEL 2 - Intermediate
 LEVEL 3 - Advanced
 E - Everyone



More Sessions on following page

CONFERENCE SCHEDULE

FRIDAY, OCTOBER 3, 2008 (continued)

6. "Coin Toss"
Financial Planning (E)
*Financial Compass – Troy Barrilleaux
 and Tim Rosen – Financial Planners*

7. "The Juggler"
Creative Financing (Level 3)
*Linda Hamilton, CEO, CSEO, CEI,
 Stewart Title*

12:15 p.m. – 12:45 p.m. **Expo Break**

12:45 p.m. – 2:15 p.m. **Luncheon with Guest Speaker (1.0 Credits)**
John Seymour, US Senator
Retired and Past President of CAR

2:15 p.m. – 2:30 p.m. **Expo Break**

2:30 p.m. – 4:00 p.m. **Breakout Sessions (1.5 Credits)**

8. "Whack-A-Mole"
Interview Tips for Managers (Level 2)
*Ginger Frankel, CSEO, CEI,
 Old Republic Title*

9. "House of Horrors"
Title and Escrow Claims (E)
Laura Lowe, LandAmerica Financial Group

10. "Tilt-A-Whirl"
TSG's and Foreclosure Process (Level 2)
*Steve Dunsmore, Stewart Title and
 Dean Kirchen, Stewart Title*

11. "Step Right Up"
Your Desk, Your Business (E)
*Paul Johnston, Vice President,
 Old Republic Title Company*

12. "Claim Your Winnings"
Reverse Mortgages (Level 2)
*Katherine Luna, Reverse Mortgage
 Division LSI-Local Solutions
 Dave Shean, CSEO, CEI,
 Escrow Essentials*

4:00 p.m. – 5:30 p.m. **Cocktail Reception on the Midway**

Evening on Own

SATURDAY, OCTOBER 4, 2008

(6.0 Professional Designation Credits Available)

7:00 a.m. – 4:00 p.m. **Registration Open**

7:00 a.m. – 8:00 a.m. **Continental Breakfast in Exhibit Hall**

7:00 a.m. – 5:00 p.m. **"Enjoy the Midway"**
Escrow Expo Open

8:00 a.m. – 9:30 a.m. **Breakout Sessions (1.5 Credits)**

13. "Carnival of Escrow"
Escrow Refresher (Level 2)
*Laura Bina, Escrow Operation Manager,
 North American Title Company*

14. "The Fun House 1"
Introduction to Mobile Home Escrows (Level 2)
*Nancy Stalter, CEO, CSEO, CBSS, CMHS,
 CEI, The Business of Escrow
 Tamara Stoebe, CEO, CSEO, CBSS, CMHS,
 CEI, Federal Escrow/Troth REALTORS
 GMAC Real Estate*

15. "Bumper Cars"
State and National Legislative Update (E)
*Michael Belote, Esq., Legislative Advocate,
 California Advocates, Inc. and Ann Dunham,
 AEA President*
 The year in review – annual legislative
 update. Wrap up of the 2008 legislative
 year in California and a report from the
 American Escrow Association on issues that
 are current and on the horizon.

9:30 a.m. – 10:00 a.m. **Expo Break**

10:00 a.m. – 11:30 a.m. **Breakout Sessions (1.5 Credits)**

**16. "Being Interviewed by the
 Bearded Lady" (E)**
**How to market and present yourself in
 an interview.**
*Ginger Frankel, CSEO, CEI,
 Old Republic Title*

17. "The Fun House 2"
Advanced Mobile Home Escrows (Level 3)
*Nancy Stalter, CEO, CSEO, CBSS, CMHS,
 CEI, The Business of Escrow
 Tamara Stoebe, CEO, CSEO, CBSS, CMHS,
 CEI, Federal Escrow/Troth REALTORS
 GMAC Real Estate*

CONFERENCE SCHEDULE

SATURDAY, OCTOBER 4, 2008 (continued)

**18 "The Dunk Tank"
Legal Claims (E)**
Rose Pothier, Esq., Pothier & Associates

**19. "Merry Go Round and Round Again
of Taxes" (E)**
Michael Haas, CPA, Morton Alan Haas & Co.

**20. "House of Mirrors"
RESPA Update (Level 2 and 3)**
Phil Schulman, Esq., K & L Gates

11:30 a.m. – 11:45 a.m. Expo Break

11:45 a.m. – 1:15 p.m. Annual Awards Luncheon

1:15 p.m. – 1:30 p.m. Expo Break

1:30 p.m. – 3:00 p.m. Breakout Sessions (1.5 Credits)

**21. "The Shooting Gallery"
Mock Trial Part 1 (E)**
Stephen Davis, Davis & Davis, LLP

22. "CEO Prep Class" (Level 2)
Lena Signor, CEO, CSEO, CEI, Northern California Escrow Services, Inc., and Marilynne McDuffey, CSEO, LandAmerica Financial Group, Inc.

**23. "Ferris Wheel"
Foreclosures – General Overview (E)**
Christian Spring, Esq., Foreclosure Resources

**24. "Free Fall"
Mortgage Fraud (E)**
*Chris Christopher, Detective, Los Angeles Sheriff's Department, Real Estate Fraud Unit
David Fleck, Deputy District Attorney for the Real Estate Fraud Unit of the Los Angeles District Attorney*

**25. "Ring Toss"
Notes and Deeds of Trust
(Level 1 and Above)**
*Sandy Rose, CSEO, CEI,
Old Republic Title Company*

3:00 p.m. – 3:30 p.m. Final Expo Break – Prize Drawings

3:30 p.m. – 5:00 p.m. Breakout Sessions (1.5 Credits)

**26. "Reload – Shooting Gallery"
Mock Trial Part 2 (E)**
Stephen Davis, Davis & Davis, LLP

27. "CSEO Prep Class" (Level 2)
*Rosanna Medeiros, CEO, CSEO and Donna Inman, CSEO, CEI,
LandSafe Real Estate Closing Services*

**28. "Fortune Teller"
Exchanges (Level 2 and 3)**
Dino Champagne, Asset Preservation, Inc.

**29. "The Jester"
Creative Financing (Level 1 and Above)**
*No. Linda Hamilton, CEO, CSEO, CEI,
Stewart Title*

**30. "Penny Arcade"
Docs A-Z – Title & Escrow (E)**
*Dave Shean, CSEO, CEI,
Escrow Essentials
Lee McDonald, Commercial Title Officer,
LandAmerica Financial Group*

7:00 p.m. – 11:00 p.m. Conference Party

SUNDAY, OCTOBER 5, 2008

**(3.0 Professional Designation Credits Available)
All events held at the Hyatt Regency, Long Beach.**

7:30 a.m. – 12:30 p.m. Registration Open

**8:00 a.m. – 5:00 p.m. Professional Designation Exam –
Separate Registration Required**

9:00 a.m. – 10:30 a.m. Breakout Sessions (1.5 Credits)

**31. "Face Painting"
Public Speaking For Escrow
Professionals (You Can Do It!) (E)**
*Lexi Howard, CEO, CSEO, CEI,
Chicago Title Company*

**32. "The Shell Game"
Using MS Outlook and Excel - Tools for
marketing behind the desk (E)**
*Cindy Beck, CEO, CEI,
LandAmerica Southland*

10:30 a.m. – 11:00 a.m. Hotel Check out

**11:00 a.m. – 12:30 p.m. "Ring the Bell"
Brunch with Guest Speaker (1.5 Credits) (E)**
*Margaret Foster, Executive Vice President,
LandAmerica Financial Group, Inc.*

12:30 p.m. Conference ends

**LEVEL 1 – Beginner
LEVEL 2 – Intermediate
LEVEL 3 – Advanced
E – Everyone**

EXHIBITORS/MIDWAY MAP

Accommodator Finance Company
Bancserv
Bank of the West
Business of Escrow
Chicago Deferred Exchange
Cookie Lee Jewelry
Crystal Persuasions
Disclosure Source
Exchange Resources, Inc.
Exeter 1031 Exchange Services, LLC
Flex Closing Corp

FileSource
First American Exchange Co.
Golden State Overnight
Guaranty Bank
Investment Property Exchange Services
Jewels by Parklane
OnTrac
RBJ Computers
Software Sourcing
SMS
Wescom Insurance Svcs.

LONG BEACH CONVENTION CENTER GRAND BALLROOM A

ALL BOOTHS 8'X10' UNLESS OTHERWISE NOTED.

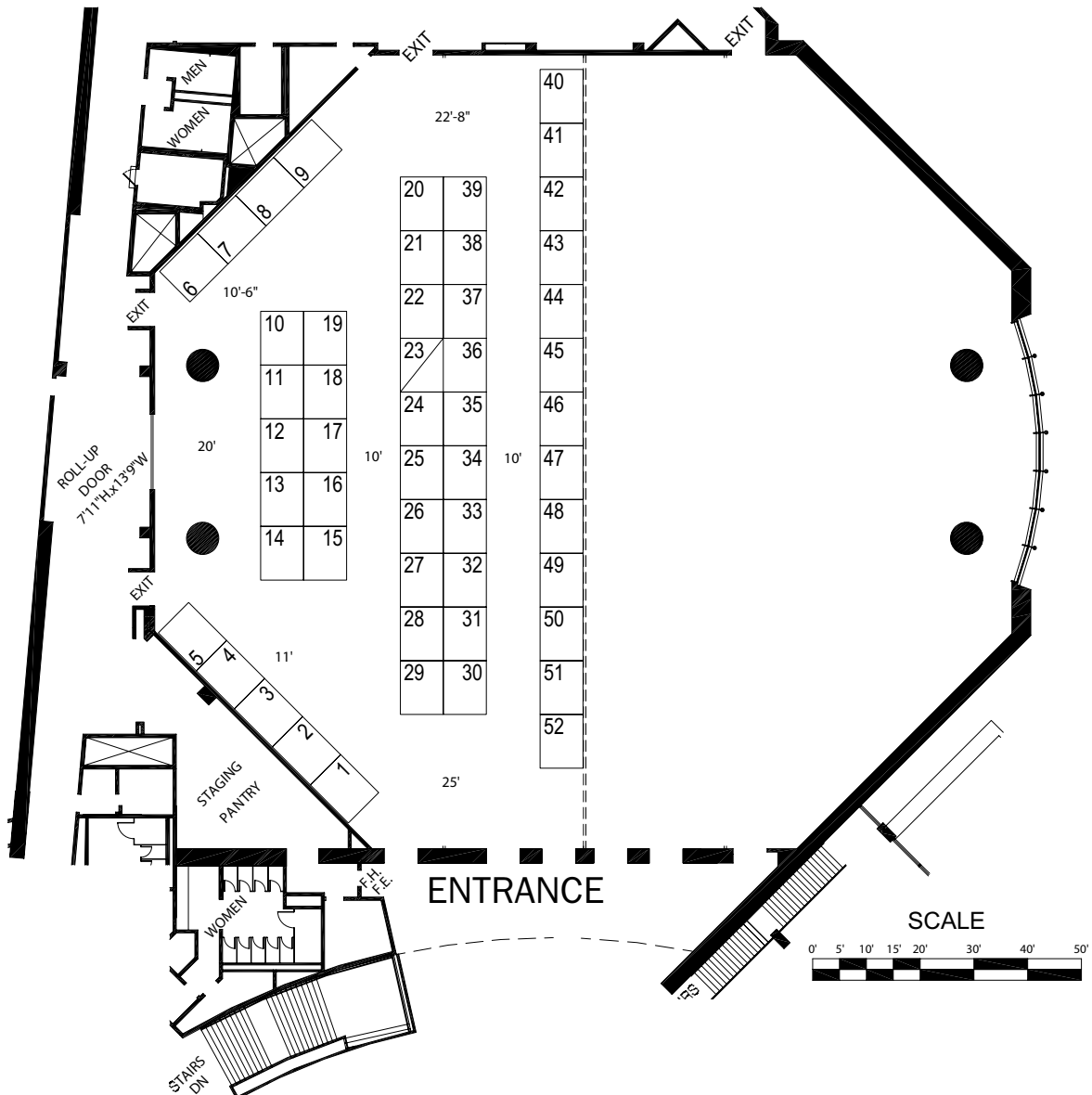

CONVENTION CENTER MAP

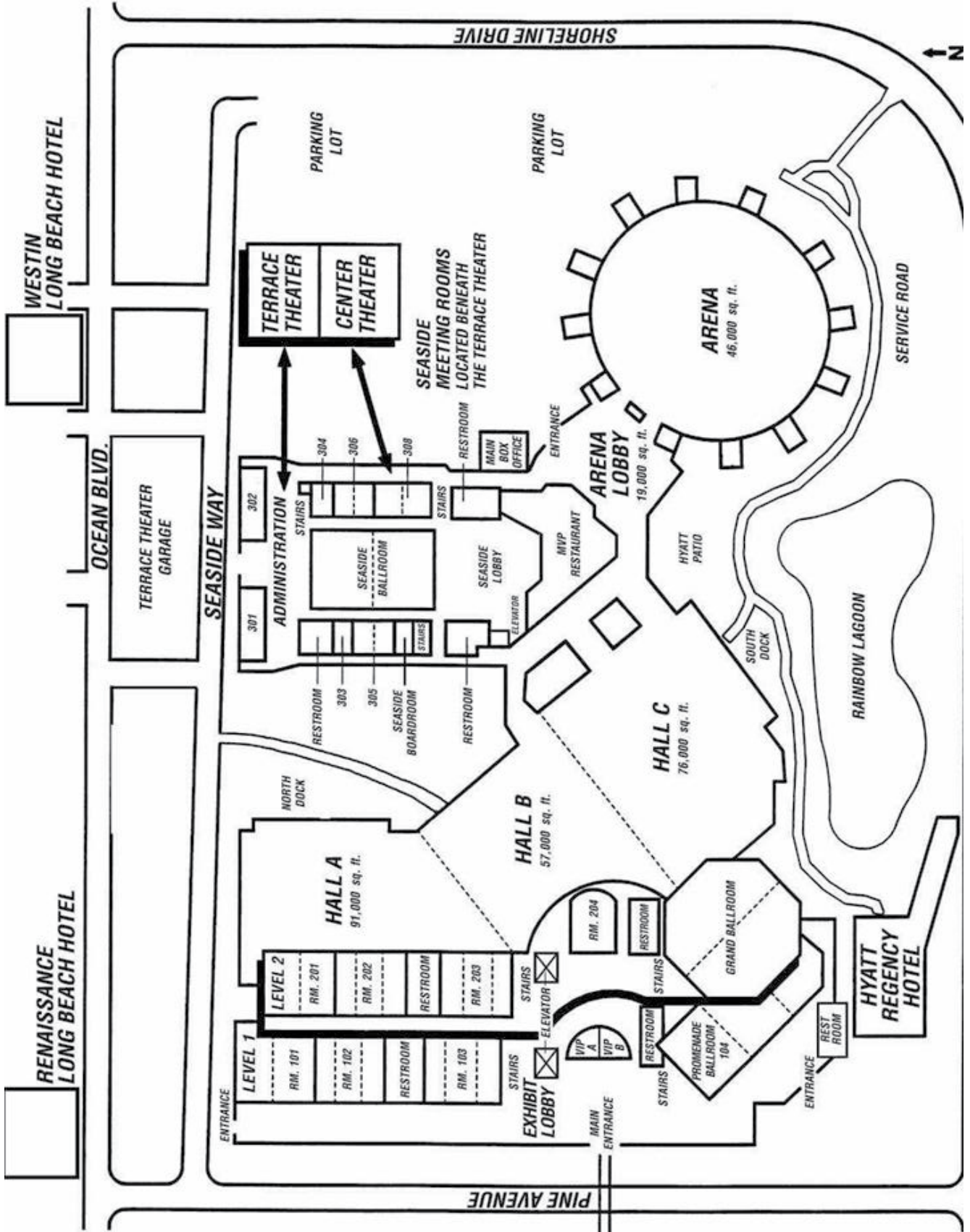

CALIFORNIA ESCROW ASSOCIATION 53RD ANNUAL EDUCATION CONFERENCE

October 2-5, 2008 • Long Beach
REGISTRATION FORM

IMPORTANT – PLEASE COMPLETE AND RETURN BOTH SIDES OF THIS FORM

PLEASE TYPE OR PRINT *For additional registrations, please duplicate this form*

Last Name: _____ First Name: _____
 Title: _____ Company: _____
 Address: _____ Home Address Business Address
 City: _____ State: _____ Zip: _____
 Telephone: _____ Fax: _____ E-Mail: _____

IMPORTANT:

Please initial here if you DO NOT want your name and address provided to our vendors/exhibitors/sponsors: _____

PLEASE CHECK ALL THAT APPLY

- | | | | |
|--|--------------------------------|--|--|
| <input type="checkbox"/> Member | <input type="checkbox"/> CEO | <input type="checkbox"/> CEI | Name of Regional Association(s)

_____ |
| <input type="checkbox"/> Non-Member | <input type="checkbox"/> CLEO | <input type="checkbox"/> CBSS | |
| <input type="checkbox"/> Speaker | <input type="checkbox"/> CSEO | <input type="checkbox"/> CMHS | |
| <input type="checkbox"/> Exhibitor | <input type="checkbox"/> CSLEO | <input type="checkbox"/> Vegetarian Meals | |
| <input type="checkbox"/> 1st Time Attendee | <input type="checkbox"/> CET | <input type="checkbox"/> Disability: _____ | |
| | | | |

REGISTRATION FEES

- | | |
|---|-----------------|
| <input type="checkbox"/> PACKAGE "A" (FULL REGISTRATION)
Includes all events including lunches for Friday, Saturday and Sunday, excluding Saturday night party. | \$405.00 |
| <input type="checkbox"/> PACKAGE "B" (FRIDAY AND SATURDAY REGISTRATION)
Includes all events including lunches for Friday and Saturday, excluding Saturday night party. | \$370.00 |
| <input type="checkbox"/> PACKAGE "C" (SATURDAY AND SUNDAY REGISTRATION)
Includes all events including lunches for Saturday and Sunday, excluding Saturday night party. | \$330.00 |
| <input type="checkbox"/> PACKAGE "D" (SINGLE DAY REGISTRATION - check day/s)
•Single day purchase includes workshops and luncheon/brunch only for one day.
<input type="checkbox"/> FRIDAY <input type="checkbox"/> SATURDAY <input type="checkbox"/> SUNDAY | \$225.00 |

REGISTRATION FEE: \$ _____

DISCOUNTS

- | | |
|---|---|
| <input type="checkbox"/> EARLY BIRD DISCOUNT BEFORE SEPTEMBER 2, 2008 (postmarked before 9/2/08) | Deduct 10% off the above package price: (\$ _____) |
| <input type="checkbox"/> PROFESSIONAL DESIGNATION HOLDER DISCOUNT | (\$ 25.00) |
| <input type="checkbox"/> FIRST TIME ATTENDEE DISCOUNT (Does NOT apply to P.D. Holders) | (\$ 25.00) |

SUBTOTAL #1 – TOTAL INDIVIDUAL DISCOUNTS: (\$ _____)

SUBTOTAL #2 – REGISTRATION FEE LESS DISCOUNTS: \$ _____

- | | |
|--|-------------------|
| <input type="checkbox"/> COMPANY DISCOUNT (For companies sending 3 or more employees to the conference, take 10% off of the SUBTOTAL #2 amount. Registration forms for each employee <u>must</u> be sent together with <u>one</u> company payment.) | (\$ _____) |
|--|-------------------|

SUBTOTAL #3 – TOTAL REGISTRATION FEE: \$ _____

PLEASE COMPLETE FORM CONTINUED ON OTHER SIDE

CONTINUED FROM OTHER SIDE

Last Name _____ **First Name** _____

EXTRAS

ENTER AMOUNT FROM SUBTOTAL #3 ON PREVIOUS PAGE: \$ _____

- NON-MEMBERS**
\$25 may be applied to 2009 membership if application is received by December 31, 2008. \$ 60.00
- P.D. C.E. BARCODE CARD REPLACEMENT** \$ 15.00
- SATURDAY NIGHT PARTY**
Tickets – \$75.00 per person.
Number of single tickets @ \$75.00 _____ \$ _____
- ADDITIONAL MEAL TICKETS (please fill in total amount)** \$ _____
 - Friday Lunch: Quantity _____ @ \$45.00** \$ _____
 - Saturday Lunch: Quantity _____ @ \$45.00** \$ _____
 - Sunday Brunch: Quantity _____ @ \$45.00** \$ _____
- LATE REGISTRATION FEE (applies to registrations received after 9/22/08 and on-site)** \$ 60.00

GRAND TOTAL DUE: \$ _____

EDUCATIONAL SESSIONS

I plan to attend the following educational sessions. Note, this is so that we have an estimated attendance count. You are not committed to attend your selection, nor does CEA guarantee your space in the session. Session times and topics are subject to change.

- 1 2 3 4 5 6 7 8 9 10 11 12 13 14 15
- 16 17 18 19 20 21 22 23 24 25 26 27 28 29 30
- 31 32 33- Brunch Notary Class

PAYMENT *Please check all that apply*

Enclosed is: Company Check # _____ Personal Check # _____

Charge my Credit Card: MC VISA Amount of \$ _____

Card No. _____ Exp. _____ 3-4 Digit Security Code _____

Name on Card: _____ Signature of Cardholder: _____

Credit Card Billing Address: _____

For Company Discount, please complete:

*Name of Company: _____ Check Number: _____ Amount: _____

Names of Other Registrants: _____

Cancellations must be submitted in writing to CEA Headquarters.

Cancellations received on or before September 22, 2008 will receive a full refund less a \$50.00 per person processing fee. No refunds will be granted after September 22nd.

PLEASE RETURN REGISTRATION FORM WITH PAYMENT TO:

**CEA Headquarters
2520 Venture Oaks Way, Suite 150
Sacramento, CA 95833**

**(916) 239-4075 – phone
(916) 924-7323 – fax
www.ceaescrow.org / cea@camgmt.com**

GOLF REGISTRATION FORM



2008 ANNUAL GOLF TOURNAMENT REGISTRATION

Rancho San Joaquin Golf Course in Irvine is the location of our 2008 tournament. Please plan to join us.

DATE: Thursday, October 2, 2008

TIME: 10:30 am – Check In; 12:30 – Shotgun Start

PLACE: Rancho San Joaquin Golf Course, One Ethel Coplen Way, Irvine, CA 92612
949.786.5522 • www.rsj.americangolf.com

COST: \$95

DETAILS: Includes golf cart, lunch, awards, and post-tournament party. Prizes awarded for longest drive, closest to pin, hole-in-one, and putting contest

Please complete this form with your name and/or your foursome:

PLAYER _____	COMPANY _____
PLAYER _____	COMPANY _____
PLAYER _____	COMPANY _____
PLAYER _____	COMPANY _____

CONTACT PHONE # _____

E-MAIL ADDRESS _____

COMPANY _____

CHECK ENCLOSED PAYABLE TO CEA, IN THE AMOUNT OF \$ _____

Check must cover \$95 per player.

Make check payable to California Escrow Association

SPONSORSHIP OPPORTUNITIES LISTED ON THE REVERSE SIDE

DEADLINE TO REGISTER: September 15, 2008

No refunds for cancellations received after September 15, 2008

RETURN TO:

Mark Coniglio • City National Bank • 4275 Executive Square #750

La Jolla, CA 92037 • Ph: .642.4980 / Fax: 858.642.4988

E-mail: mark.coniglio@cnb.com



2008 ANNUAL GOLF TOURNAMENT SPONSORSHIP FORM

DATE: Thursday, October 2, 2008

PLACE: Rancho San Joaquin Golf Course, One Ethel Coplen, Irvine, CA 92612
949.786.5522 • www.rsj.americangolf.com.

Thursday, October 2, 2008

Sponsorships Available:

Hole-In-One Sponsor (cost)
Longest Drive Sponsor (\$200.00)
Closest to Pin Sponsor 2 available (\$200.00/each)
Putting Contest Sponsor (\$100.00)
Golf Towel or Golf Ball Sponsor (cost)
Tee Sponsor (\$100.00)
Tee Sponsorships \$450.00
(includes a foursome for golf)

Call Mark Coniglio for sponsorship specifics.

Company Name: _____

Contact Person: _____

Phone #: _____

Type of Sponsorship Requested: _____

Check Enclosed – Amount: _____

All checks to be made payable to the California Escrow Association and sent in with this sponsor form. Please indicate which sponsorship you are interested in. Include business card for signage.

Complete this form and send with check payable to CEA, to:

Mark Coniglio • City National Bank • 4275 Executive Square #750
La Jolla, CA 92037 • Ph: 858.642.4980 / Fax: 858.642.4988
E-mail: mark.coniglio@cnb.com

CALIFORNIA ESCROW ASSOCIATION MEMBERSHIP APPLICATION



Membership Categories

Individual Active Member (\$210) – Includes CEA, the American Escrow Association (AEA), and one Regional Association. (Engaged in the escrow settlement profession; Full voting privileges; Regional membership.)

State Membership – Individual Active Member (\$210) – Includes CEA and AEA only; no Regional Association. (Engaged in the escrow settlement profession; Full voting privileges; no regional membership.)

Individual Intern Member (\$60) – Includes CEA and one Regional Association, no AEA. (An individual who participates in the escrow or settlement process as a secretary, assistant, or any other position that is clerical and/or at an entry level. Granted one-time for a period not to exceed two consecutive years; no voting privileges; regional membership.)

State Membership – Individual Intern Member (\$60) – Includes CEA only; no AEA and no Regional Association. (An individual who participates in the escrow or settlement process as a secretary, assistant, or any other position that is clerical and/or at an entry level. Granted one time for a period not to exceed two consecutive years; no voting privileges, no regional membership.)

State Associate Member (\$160) – Includes CEA only, no Regional Association, no AEA. (An individual in an allied field not engaged in the practice of escrow; no voting privileges.)

Individual Associate Member (\$185) – Includes CEA, one Regional Association & no AEA. (An individual in an allied field not engaged in the practice of escrow; no voting privileges.)

Inactive (\$100) – Includes CEA and one Regional Association; no AEA. (Past Active members or State Active members who are no longer engaged in their profession, either permanently or temporarily; no voting privileges.)

New Renewal

Please allow up to 3 weeks for new member processing.

A. Individual Membership

Membership Category: INDIVIDUAL ACTIVE STATE INDIV. ACTIVE INDIVIDUAL INTERN STATE INDIV. INTERN STATE ASSOCIATE INACTIVE

Name: _____ Title: _____ Referred by: _____

For categories other than State, please choose a primary regional membership using the CEA map.

If no region, please select State. Region: _____ State (no region)

Employment Category (check one): TC – Title Company S/L/B – Savings & Loan or Bank
 BE – Broker Escrow LE – Licensed Escrow OT – Other

Please check this box if you DO NOT want CEA to release your contact information to industry related entities.

Please check this box if you DO NOT want CEA to include your contact information on the public area of the CEA Web site.

Membership is based on a calendar year, on an individual basis, and is non-transferable.

B. Business Address

Company Name _____

Address _____

City / State / Zip _____

Phone _____ Fax _____

E-mail _____

C. Home Address

Address _____

City / State / Zip _____

Phone _____ Fax _____

Mobile Phone _____

For mailing and online membership directory purposes, please use my (check one): Business Address Home Address

D. Payment

Amount: _____

CHECK Check # _____ Company Personal

CREDIT CARD MasterCard Visa

C.C.# _____ Exp: _____

Name on Card: _____

Billing Address _____

Signature: _____

In making this application, I certify that the above is true and correct and I agree to abide by the Bylaws of the above named Regional Association and the California Escrow Association and the American Escrow Association, if appropriate.

Contributions or gifts (including membership dues) to the CEA are not tax deductible as charitable contributions. Pursuant to the Federal Revenue Reconciliation Act of 1993, association members may not deduct as ordinary and necessary business expenses, that portion of association dues dedicated to direct lobbying activities. Based upon the calculation required by law, 8% (Intern) or 16.6% (all others) of the State Dues payment only should be treated as nondeductible by CEA members. Please consult your tax advisor for tax credit/deduction information.

Signature _____

Date _____

When completed, return form and payment to:

California Escrow Association, 2520 Venture Oaks Way, Suite 150 • Sacramento, CA 95833
(916) 239-4075 – phone • (916) 924-7323 – fax • cea@camgmt.com • www.ceaescrow.org



2520 Venture Oaks Way, Suite 150
Sacramento, CA 95833

Pre-Sort
U.S. Postage
PAID
Permit #2731
Sacramento, CA



CALIFORNIA ESCROW ASSOCIATION 53RD ANNUAL EDUCATION CONFERENCE

“TOGETHER WE’RE BETTER ON THE BOARDWALK OF EDUCATION”

**OCTOBER 2-5, 2008
LONG BEACH, CALIFORNIA**

